

# Mightee Mount™ - MM Series

1. If using graphic with holes: Sandwich graphic in between Mightee Mounts (1A) and screw together with wingnuts and carriage bolts (1B).
2. If using graphic without holes: Screw Mightee Mounts (2A) together with wingnuts and carriage bolts and rest graphic on top of screws (2B).
3. For MM12 Only: Plug screw hole

**NOTE:**  
Base holds any rigid substrate up to 1" thick (as long as the substrate can hold its own weight).  
**For MM12 model only:** holds any rigid substrate up to 3/16" thick and uses screws instead of wingnuts/bolts, but assembly remains the same.

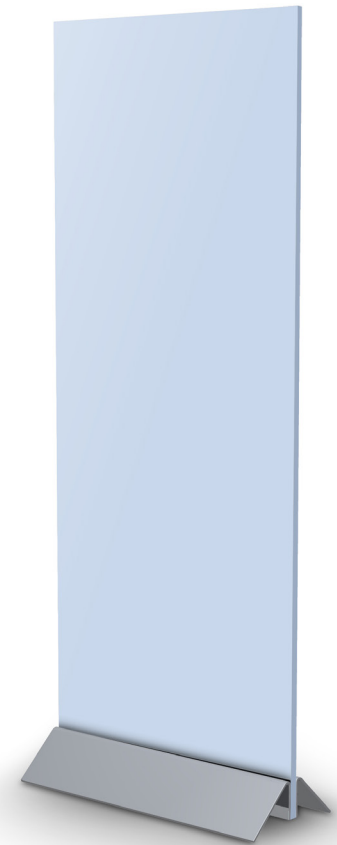
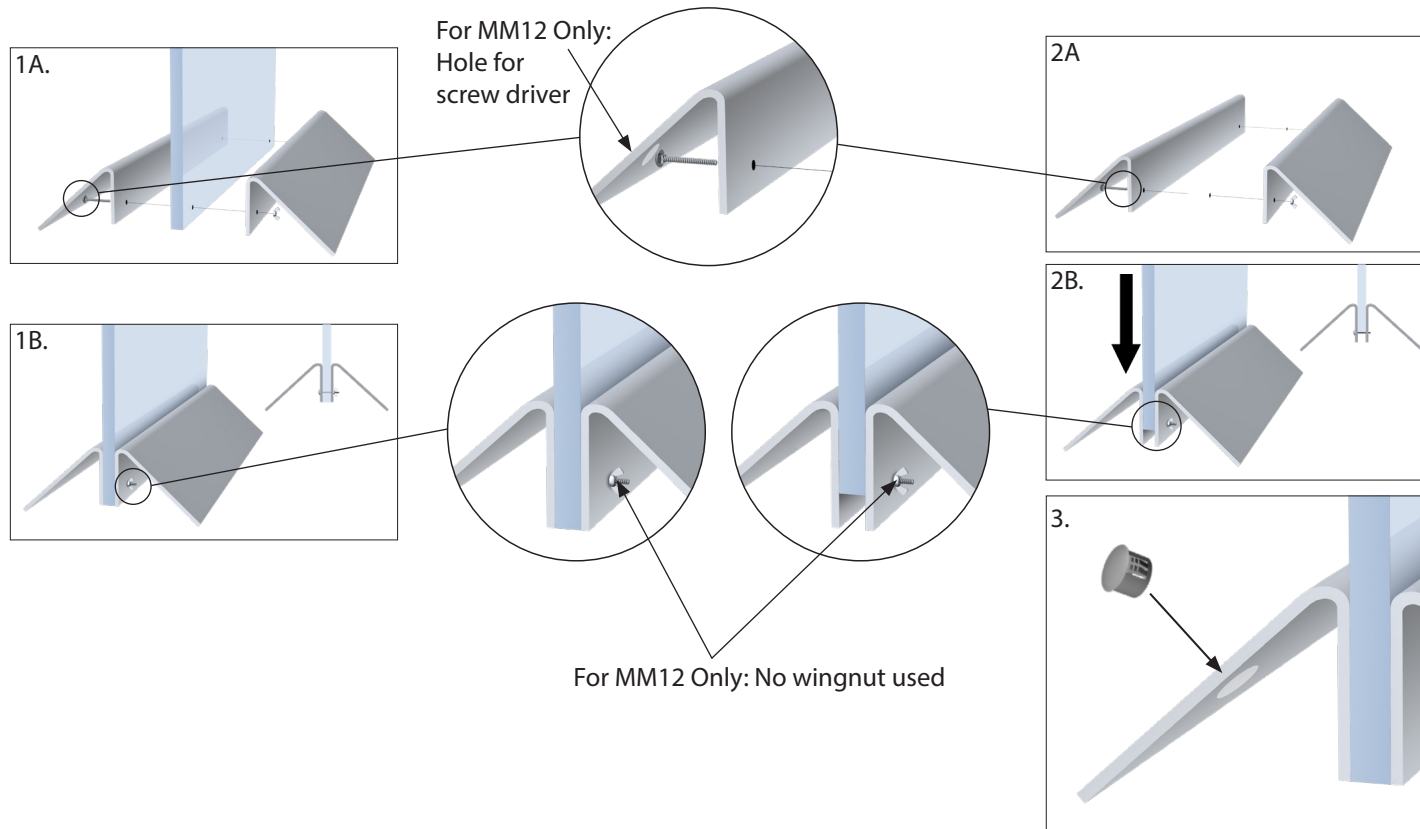

MM24 shown